

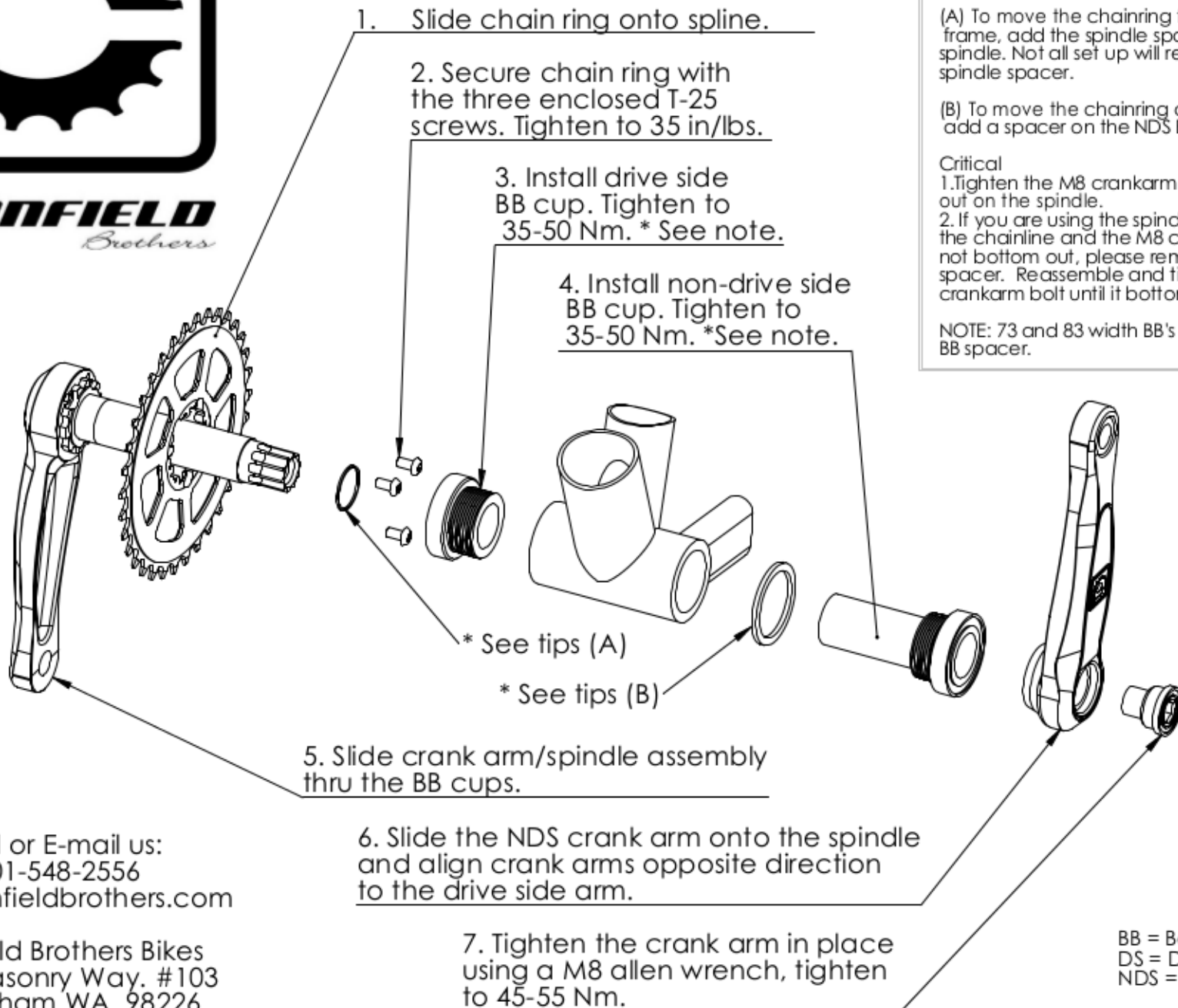

Crank Assembly Instructions



Tips:

(A) To move the chainring farther from the frame, add the spindle spacer onto the spindle. Not all set up will require the 1mm spindle spacer.

(B) To move the chainring closer to the frame, add a spacer on the NDS BB cup. 68-73 only

Critical

1. Tighten the M8 crankarm bolt until it bottoms out on the spindle.
2. If you are using the spindle spacer to adjust the chainline and the M8 crank arm bolt does not bottom out, please remove the spindle spacer. Reassemble and tighten the M8 crankarm bolt until it bottoms out on the spindle

NOTE: 73 and 83 width BB's do not require a BB spacer.

Call or E-mail us:
801-548-2556
info@canfieldbrothers.com

Canfield Brothers Bikes
2001 Masonry Way. #103
Bellingham WA. 98226

BB = Bottom Bracket
DS = Drive Side
NDS = Non Drive Side